

Dept
Qty
DC 1
ED 1
IE 1
ISO 1
PD 1
R&D 1
SD 1
QA 1
QC 1
QE 1

The information provided herein is from CONNELY Electronic Co., Ltd. and is confidential. Any disclosure to a party other than the recipient is prohibited. The intellectual properties and its rights contained herein, including but not limited to, trademarks, patents, copyrights, trade secrets, and technical know-how, are owned exclusively by CONNELY or its affiliates. Unauthorized use or reproduction of this information in any form or manner, without the prior written consent of CONNELY, may constitute a violation of applicable laws and regulations. CONNELY may enforce its intellectual property rights at its own discretion; failures or delays to exercise such rights does not constitute a waiver of such rights.

REV.	DESCRIPTION	DRAWN	CHECKED	APPROVED
A	NEW RELEASE	WPY 12/25/24'		

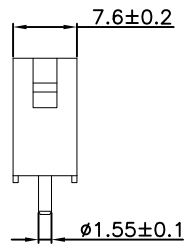
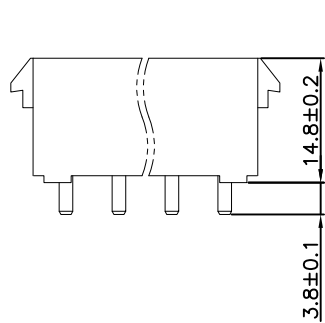

Male Terminal

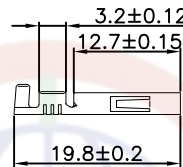

Contact:

T-DS1148-10-X X X 00

- Contact plating
- 6: Full Tin
- Mounting type
- C: Crimp type
- Housing Type
- P: Male

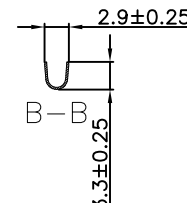
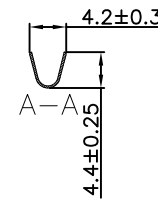
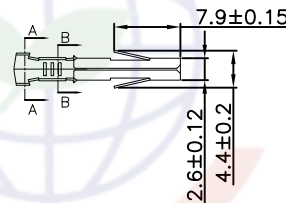
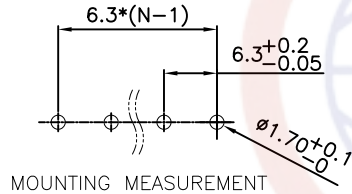
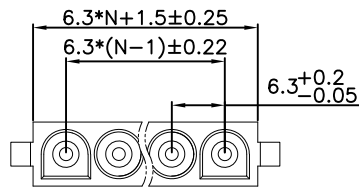

Single row
N=No. of contacts

MOUNTING MEASUREMENT

Notes:

Material:

- .Housing material: PA66
- .Contact material: Phos bronze
- .Wire range: AWG20~16#

Specification:

- .Rated voltage: 300V AC/DC
- .Rated current: 8A, 10A, 12A, 13A
- .Contact resistance: 10mΩ
- .Insulation resistance: ≥1000MΩ
- .Withstanding voltage: 1800V, AC 1 minute
- .Temperature range: -25 ~ +85°C
- .Recommend PC board thickness: 1.6mm
- .Products of the same specification should be interchangeable by different manufacturers

Product Number Code:

DS1148-10-X X X X 0 - X

- Match Type
- 1: A
- Housing Color:
- T: Transparent
- Mounting Type:
- V: V/T
- Connector Type:
- S: Female
- No. of contact:
- 1×2~1×6
- 3×2~3×5

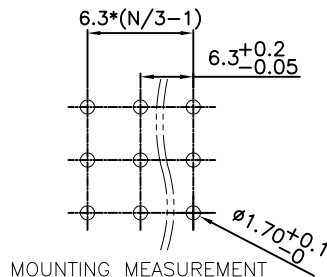
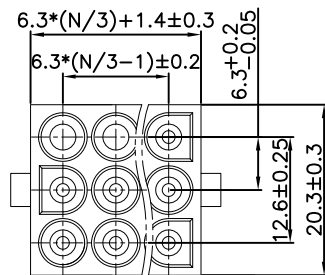
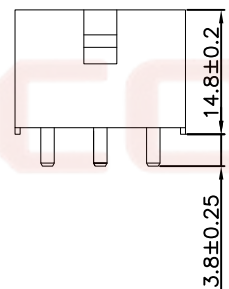
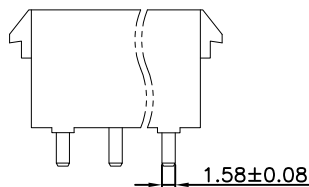

Triplex row
N=No. of contacts

MOUNTING MEASUREMENT

GENERAL TOLERANCE		ANGLE TOLERANCE	
X.	±0.60	X.	±5°
.X	±0.38	.X	±3°
.XX	±0.25	.XX	±2°

PROJECTION	TITLE
	6.3mm wire to board automotive connector (Vertical Through)
UNITS	mm
SHEET SIZE	A4
SERIES	DS1148-10 SERIES

DRAWING TYPE	CUSTOMER
SCALE	1:1 SHEET 1 OF 3
DRAWING NO.	C-DS1148-10-XXXX-X-A

晨翔电子有限公司
CONNELY CONNELY ELECTRONIC CO. LTD

The information provided herein is from CONNELY Electronic Co., Ltd. and is confidential. Any disclosure to a party other than the recipient is prohibited. The intellectual properties and its rights contained herein, including but not limited to, trademarks, patents, copyrights, trade secrets, and technical know-how, are owned exclusively by CONNELY or its affiliates. Unauthorized use of this information in any format or manner. CONNELY may enforce its intellectual property rights at its own discretion; failures or delays to exercise such rights does not constitute a waiver of such rights.

1 2 3 4 5 6 7 8

REV.	DESCRIPTION	DRAWN	CHECKED	APPROVED
A	NEW RELEASE	WPY 12/25/24'		

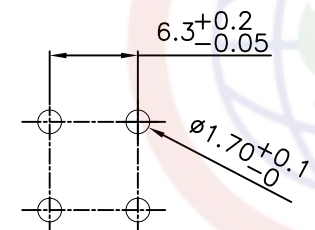
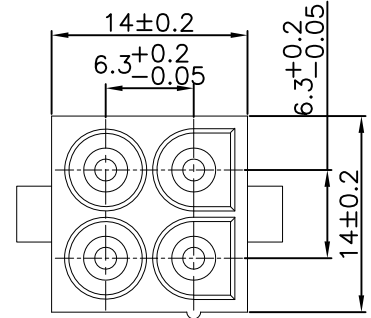
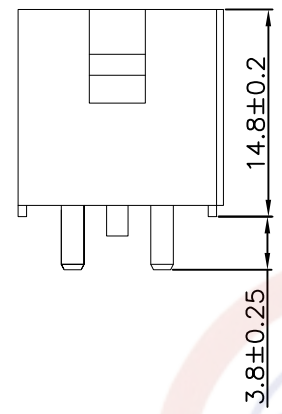
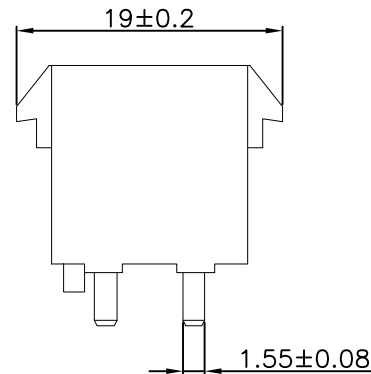

MOUNTING MEASUREMENT

Notes:
Material:
 .Housing material:PA66
 .Contact mayerial:Phos bronze
 .Wire range:AWG20~16#
Specification:
 .Rated voltage:300V AC/DC
 .Rated current:8A、10A、12A、13A
 .Contact resistance: 10mΩ
 .Insulation resistance: ≥1000MΩ
 .Withstanding voltage:1800V,AC 1 minute
 .Temperature range: -25 ~ +85°C
 .Recommend PC board thickness:1.6mm
Product Number Code:

DS1148-10-X X X X 0 - X

- Match Type
- 2:AN
- Housing Color:
- T:Transparent
- Mounting Type:
- V:V/T
- Connector Type:
- S:Female
- No.of contact:
- 2×2

Male Terminal

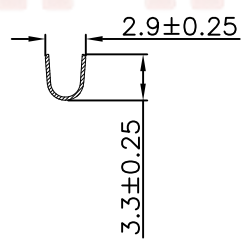
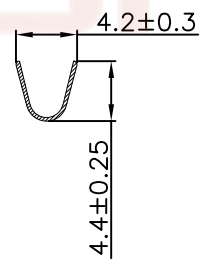
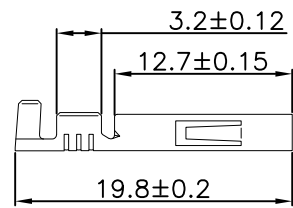

Contact:

T-DS1148-10-X X X 00

- Contact plating
- 6:Full Tin
- Mounting type
- C:Crimp type
- Housing Type
- P:Male

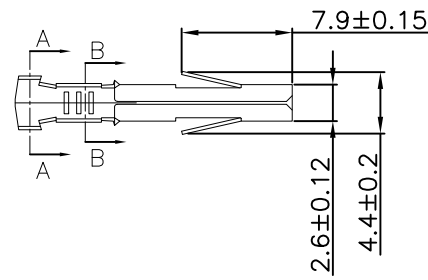

GENERAL TOLERANCE		ANGLE TOLERANCE	
X.	±0.60	X.	±5°
.X	±0.38	.X	±3°
.XX	±0.25	.XX	±2°

PROJECTION	TITLE
	6.3mm wire to board automotive connector (Vertical Through)
UNITS	mm
SHEET SIZE	A4
SERIES	DS1148-10 SERIES

DRAWING TYPE	CUSTOMER
SCALE	1:1 SHEET 2 OF 3
DRAWING NO.	C-DS1148-10-XXXXX-X-A

晨翔电子有限公司
CONNFLY CONNELY ELECTRONIC CO. LTD

1 2 3 4 5 6 7 8

The information provided herein is from CONNELY Electronic Co., Ltd. and is confidential. Any disclosure to a party other than the recipient is prohibited. The intellectual properties and its rights contained herein, including but not limited to, trademarks, patents, copyrights, trade secrets, and technical know-how, are owned exclusively by CONNELY or its affiliates. Unauthorized use or reproduction of this document in any format or manner. CONNELY may enforce its intellectual property rights at its own discretion; failures or delays to exercise such rights does not constitute a waiver of such rights.

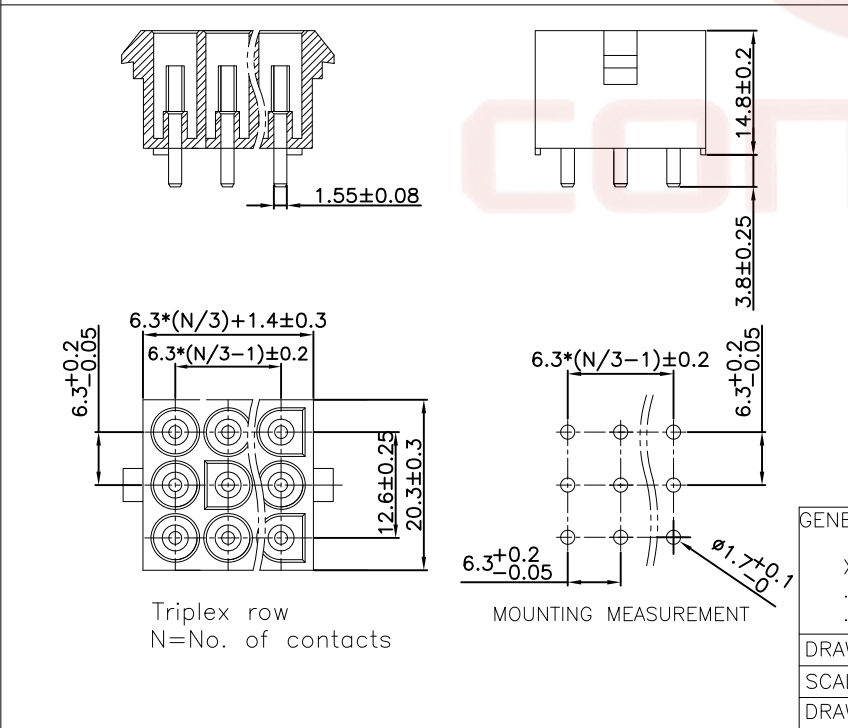
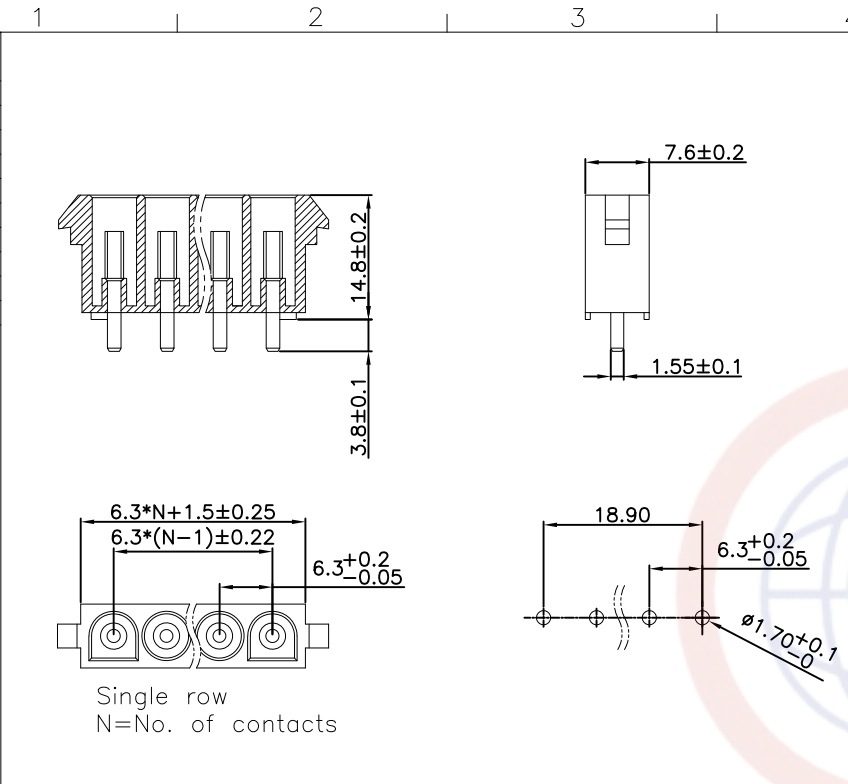

REV.	DESCRIPTION	DRAWN	CHECKED	APPROVED
A	NEW RELEASE	WPY 12/25/24'		

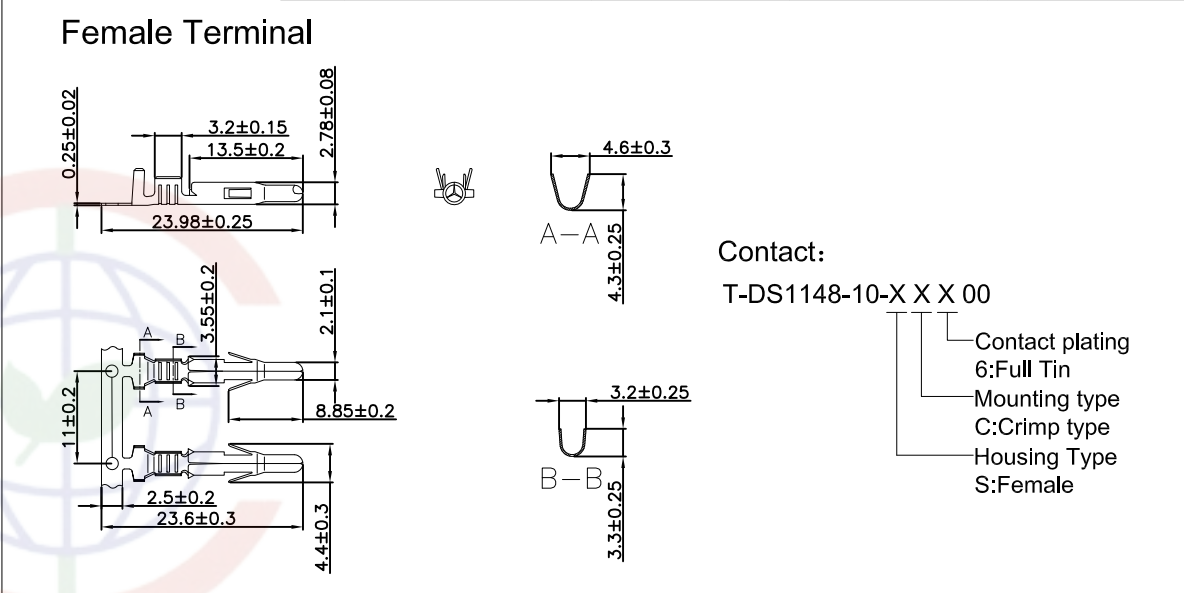

Notes:

Material:

- .Housing material: PA66
- .Contact material: Phos bronze
- .Wire range: AWG20~16#

Specification:

- .Rated voltage: 300V AC/DC
- .Rated current: 8A, 10A, 12A, 13A
- .Contact resistance: 10mΩ
- .Insulation resistance: ≥1000MΩ
- .Withstanding voltage: 1800V, AC 1 minute
- .Temperature range: -25 ~ +85°C
- .Recommend PC board thickness: 1.6mm
- .Products of the same specification should be interchangeable by different manufacturers

Product Number Code:

DS1148-10-X X X 0 - X

- Match Type
3: AK
- Housing Color:
T: Transparent
- Mounting Type:
V: V/T
- Connector Type:
S: Female
- No. of contact:
1×2~1×6
3×2~3×5

GENERAL TOLERANCE		ANGLE TOLERANCE		PROJECTION	TITLE
X.	±0.60	X.	±5°		6.3mm wire to board automotive connector (Vertical Through)
.X	±0.38	.X	±3°	mm	
.XX	±0.25	.XX	±2°	A4	SERIES DS1148-10 SERIES
DRAWING TYPE		CUSTOMER		晨翔电子有限公司 CONNELY CONNELY ELECTRONIC CO. LTD	
SCALE		1:1 SHEET 3 OF 3			
DRAWING NO.		C-DS1148-10-XXXXX-X-A			